

LEVEL 1

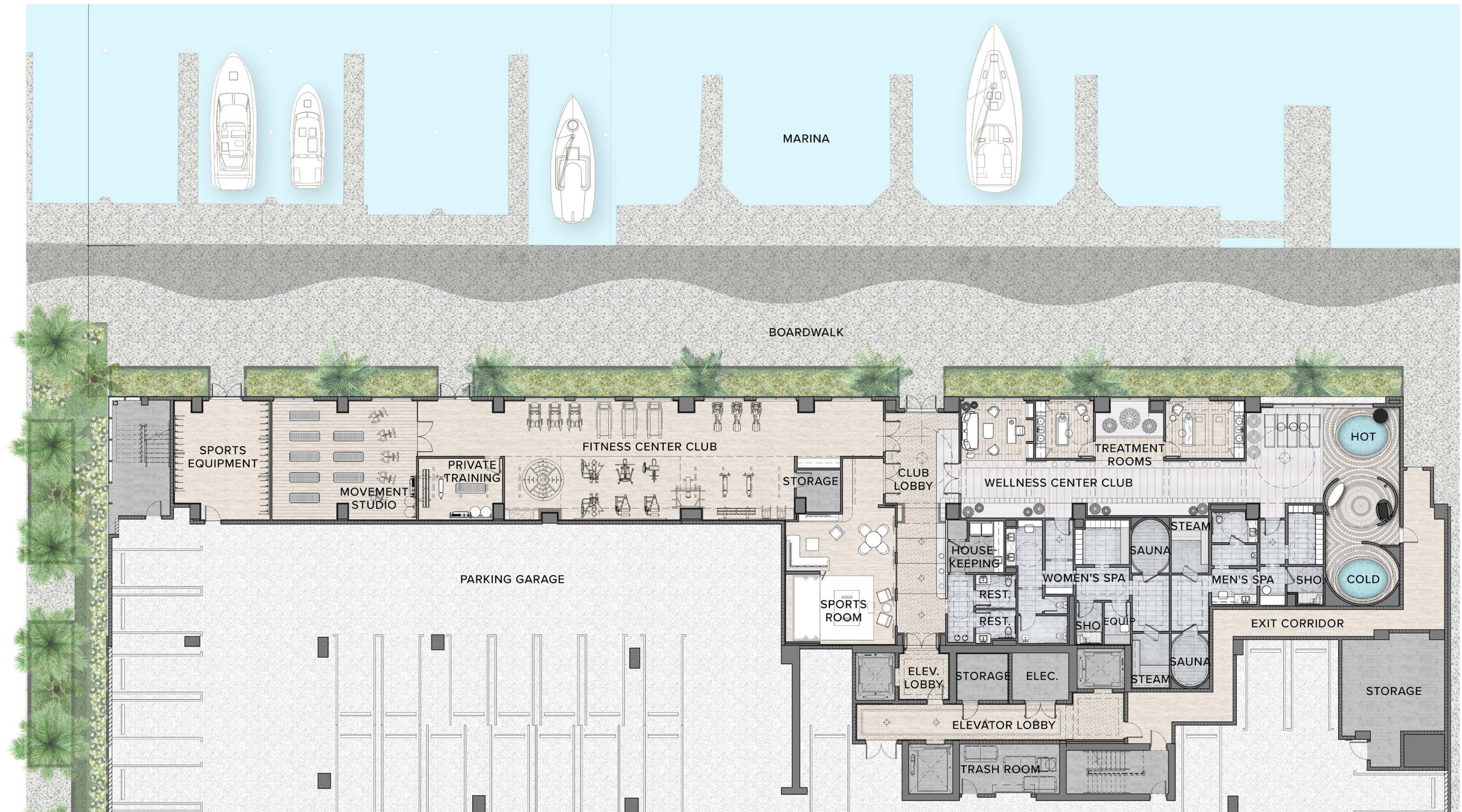

LEVEL 3

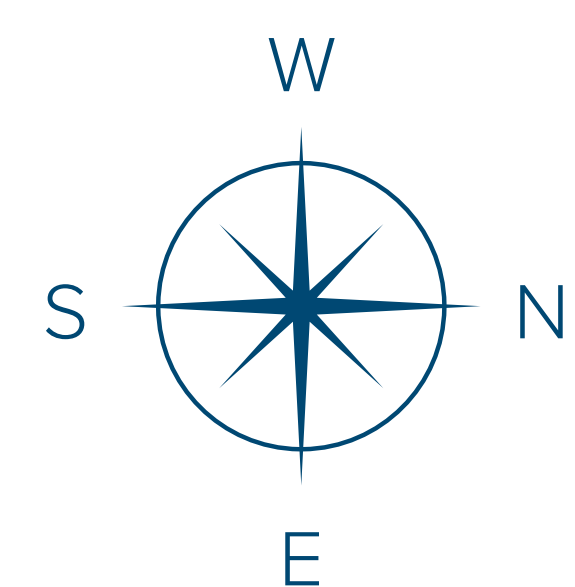
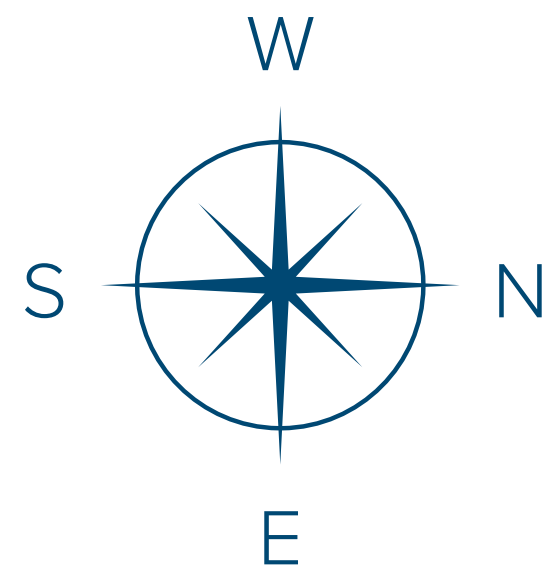

## Welcome Home to Legendary Splendor

Nestled on a quiet harbor, this private waterside oasis welcomes you into legendary splendor. Entering the stunning, staffed porte-cochere and grand light-filled lobby, you are embraced by serene sophistication and the inimitable style and grace of legendary Ritz-Carlton service. A spectacular waterside amenity terraces invites you to relax on the sun-shelf of a resort-style pool, enjoy lunch in a shady cabana, gather at the bar for a friend-filled happy hour. A tranquil wellness center and state-of-the-art fitness center, with inspiring water views, feature private treatment and training rooms, hot and cold plunge pools, and endless luxury. Resident-only bikes, kayaks, paddleboards await your pleasure, with a lushly landscaped boardwalk leading to a shimmering marina and the adventures of downtown Sarasota and Sarasota Bay beyond.